



Rock-It Shift for Sportsters (2004-Up)

With Forward Controls

INSTRUCTIONS

(Please read ALL Instructions before beginning install)

Parts included:

- 1 Rock-It Shift
- 1 Toe Shift Extension (adjusting link) w/ Hardware Kit
- 1 Reference Diagram

Part Needed:

The Rock-It Shift requires two shift pegs, you can reuse your existing shift peg and get another one, or purchase a matching pair of shift pegs from DK Custom Products.

Installation Steps:

- 1) Loosen both heim joint adjusting nuts on shifter rod assembly (#4)
- 2) Remove front shifter rod screw (#6)
- 3) Remove retaining ring (#20) from footrest/shifter lever support bracket (#8)
- 4) NOTE: Depending on your tools and patience, it may be easier to remove the footrest/shifter lever support bracket (#8) and note J-clip (#7) to get to the retaining ring (#20). If so, remove the two screws (#9) to access the retaining ring and remove it.
- 5) Remove screw (#10) from footrest/shifter lever support bracket (#8)
- 6) Remove clevis (#14) with footrest (#16) attached and shifter lever assembly (#12). Set shifter lever assembly aside, as it's not reused. Reinstall footrest/shifter lever support bracket (#8) and J-clip (#7) using two screws (#9) coated with a medium thread lock and tighten securely.
- 7) Insert clevis (#14) with footrest (#16) attached through the Rock-It Shift with shifter arm in the rear, through the footrest/shifter lever support bracket (#8) and re-install screw (#10) and retaining ring (#20). Use medium thread lock on all screws for reassembly. Tighten to specs.

- 8) Install front screw (#6) through shifter rod assembly (#4) and Rock-It Shift shifter arm, but do not tighten. Check position of rear shifter peg, and using the heim joint adjusters, shorten rod to bring rear peg up, or lengthen rod to bring rear peg down. This will require removing front screw (#6) for each adjustment. When desired position is attained, coat all threads and screw with a medium thread lock and tighten securely.
- 9) Screw front shifter peg into the Rock-It Shift adjusting link using a medium thread lock and tighten securely. NOTE: You may or may not need to use the adjusting link. You will need to determine this.
- 10) Determine approximate position of front shifter peg; up/down and forward /backward. Coat bolt threads with medium thread lock and screw into shifter. Slip adjuster onto bolt and attach so it will hold position. Once final position is attained, tighten securely.
- 11) Take your bike for a test ride and use steps 7, 8, and 9 if needed to set up your Rock-It Shift to your riding style.

Important Notes:

- The rider's safety depends on the correct installation of this kit. Please do not attempt if you have any doubts of your ability to install.
- The Threads on the Sano Black have powder coat in the four inside holes. If you use these holes, it is a good idea to "chase" the threads to clean them out before use.
- We STRONGLY recommend blue (medium) threadlocker be used on all threads.
- Refer to your manual for Torque Setting Specifications
- After using the Rock-It Shift for a while, most Riders really enjoy the extra ease in shifting. HOWEVER, it is different at first, so take extra precaution when first using the Rock-It Shift, until your foot gets used to the new way of shifting.. You will NOT be using your toe to upshift or find neutral. Be aware of how this will affect your handling of the bike.
- The user shall determine suitability of this product for his or her use. The user shall assume all risk for damage and liability to the vehicle, and for compliance of any regulations and any incurred financial obligations due to vehicle inspections.

CARE AND MAINTENANCE of Polished Aluminum Finish

Your Rock-It Shift will last for many years with proper care. Protect your Rock-It Shift from corrosive elements and harsh environment with a quality polish/sealer for aluminum. Products made for trucks are especially good as they are made specifically for that purpose. You may also elect to clear-coat your Rock-It Shift. Care and maintenance of your Rock-It Shift is your responsibility. We assume no responsibility for neglect, lack of, or improper care of your Rock-It Shift.

The Black Powder Coat finished Rock-It Shift can be cleaned the same as you clean your paint or frame.

Reference Diagram

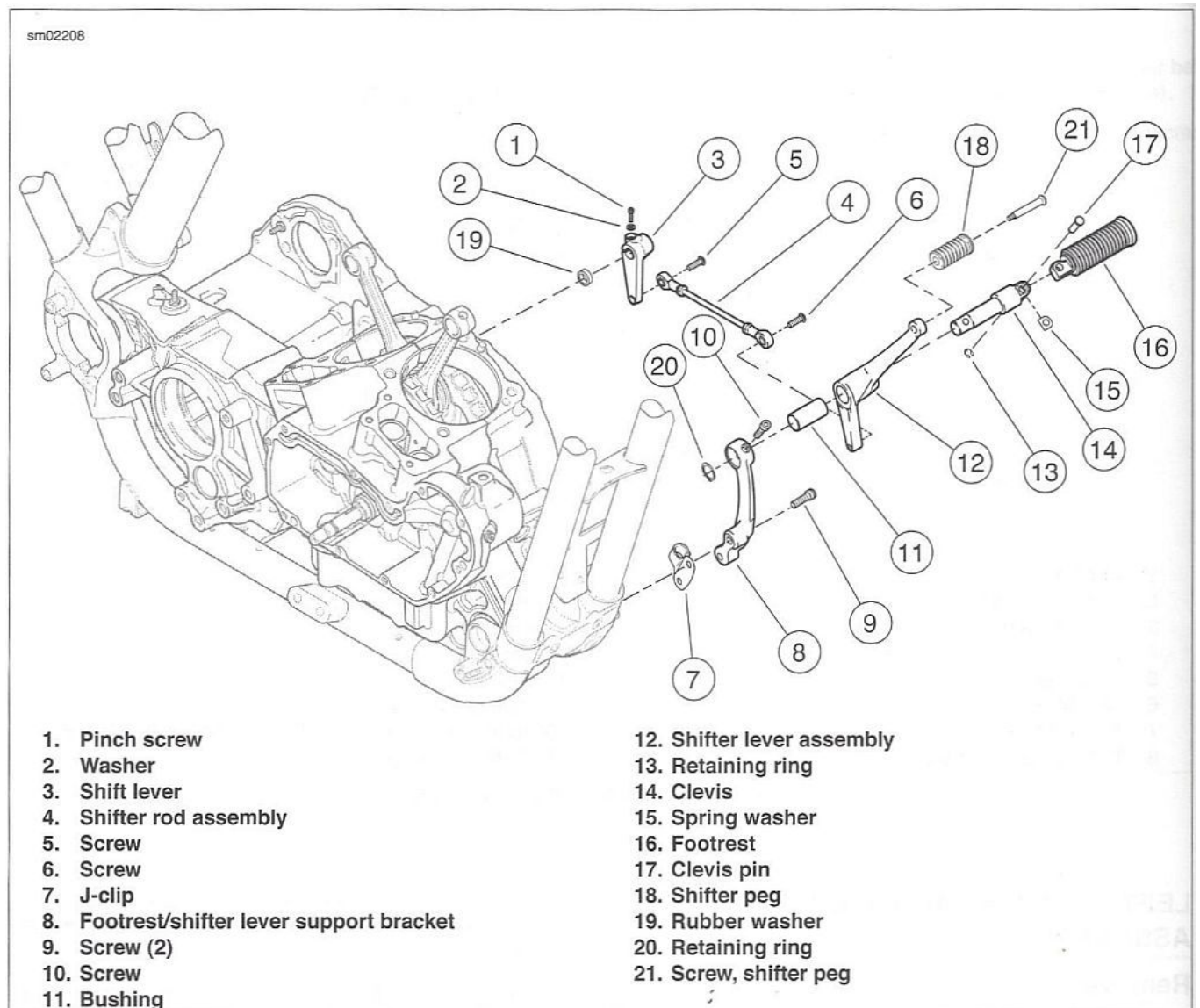

Figure 2-258. Forward Controls - Shifter Side